

**APPENDIX II  
 AMENDMENT TO THE REGION OF PEEL TRAFFIC BY-LAW 15-2013 TO IMPLEMENT  
 OVERNIGHT HEAVY TRUCK RESTRICTION, CITY OF MISSISSAUGA, WARDS 6 AND 11;  
 AND A FULL HEAVY TRUCK RESTRICTION AND REVISE AXLE LOAD WEIGHT  
 RESTRICTION, TOWN OF CALEDON, WARD 1**

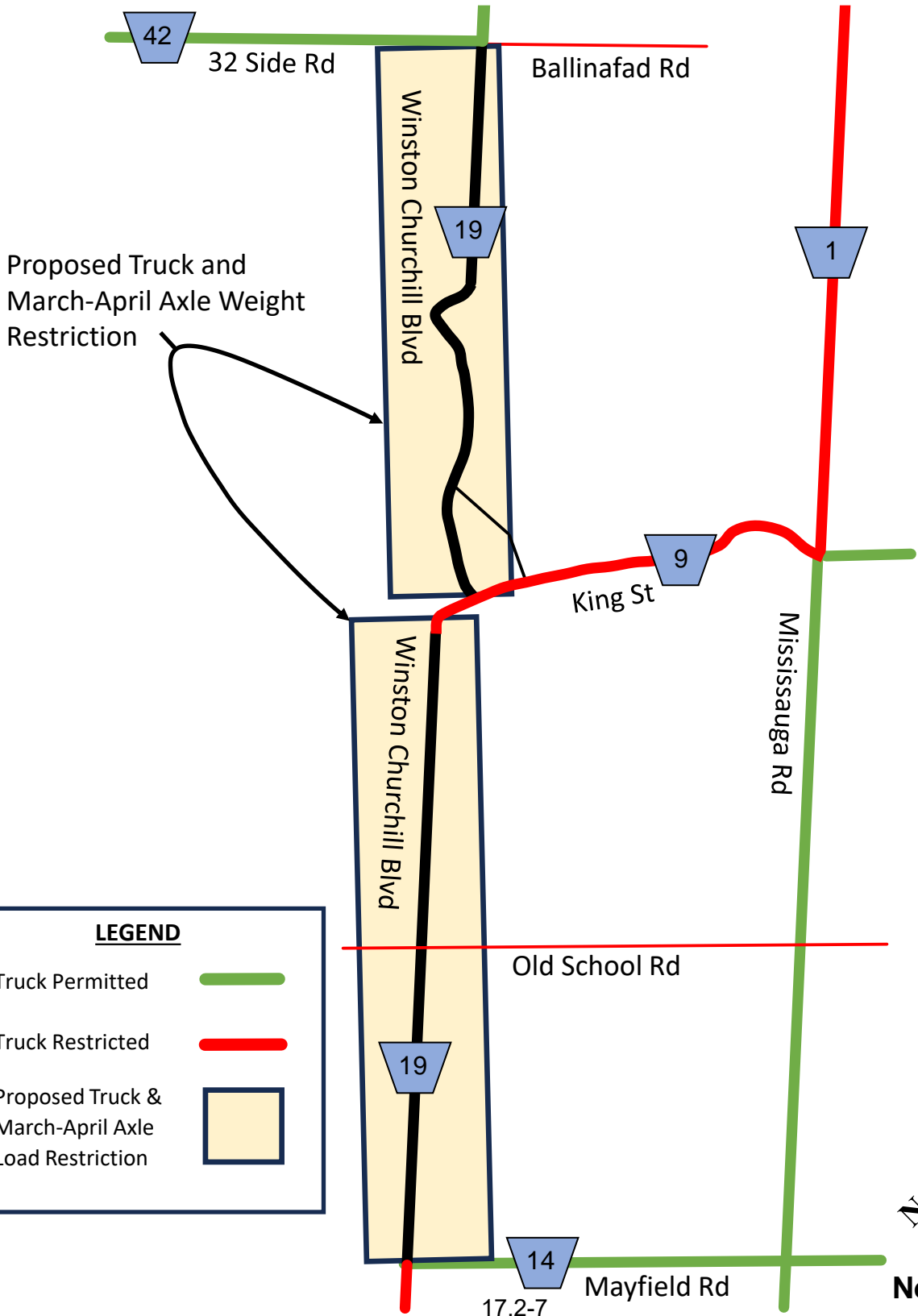

**LEGEND**

- Truck Permitted
- Truck Restricted
- Proposed Truck & March-April Axle Load Restriction

**NORTH**

**Not to Scale**